



**ESTAS**  
★★★★★  
ESTATE AGENT  
AWARDS 2022  
BEST AGENCY  
NETWORK  
The Guild of Property  
Professionals



## Rayleigh, £475,000, 3 Bed Detached Bungalow

NO CHAIN... Essex Guild Homes are delighted to Offer For Sale this VERY WELL MAINTAINED Detached Bungalow with Three Bedrooms. Situated at the End of a HIGHLY SOUGHT AFTER Cul-de-Sac Location. Long Drive Leads to single Garage. Good Size Accommodation throughout. **MUST BE SEEN**

**Council Tax Band: E EPC Rating: D**



Alexandra Road, Rayleigh, Essex, SS6 8HT

NO CHAIN..!

SITUATED AT THE END OF A HIGHLY SOUGHT  
AFTER CUL-DE-SAC LOCATION

DETACHED BUNGALOW WITH THREE BEDROOMS

20FT LOUNGE OPENS TO 12FT CONSERVATORY

MODERN FITTED KITCHEN

SEP WC AND MODERN FITTED SHOWER ROOM

VERY WELL DESIGNED LOW MAINTENANCE REAR GARDEN

LONG DRIVEWAY TO SINGLE GARAGE

LONG DRIVEWAY TO SINGLE GARAGE

VIEWING HIGHLY RECOMMENDED

---

**Energy Performance Rating:** D

**Council Tax Band:** E

**Inspected By:** Thomas Devlin-James

**Disclaimer:** The measurements indicated are supplied for guidance only,  
potential buyers are advised to re-check the measurements before committing  
to any expense.

**Entrance Porch**

5' 0" x 3' 10" (1.52m x 1.18m)

**Ground Floor WC**

5' 0" x 3' 4" (1.53m x 1.01m)

**Entrance Hall with Cupboard**

8' 3" x 3' 10" (2.51m x 1.18m)

**Lounge with Doors to Conservatory**

19' 11" x 12' 7" x (6.07m x 3.83m)

**Conservatory with Doors to Rear Garden**

11' 11" x 10' 10" x (3.29m x 3.63m)

**Modern Fitted Kitchen**

9' 9" x 8' 2" x (2.49m x 2.98m)

**Inner Hallway with Cupboard**

3' 9" x 4' 9" (1.14m x 1.46m)

**Bedroom One to Front**

11' 5" x 8' 1" (3.49m x 2.47m)

**Bedroom Two to Rear**

11' 10" x 9' 4" (2.84m x 3.61m)

**Bedroom Three to Front**

12' 3" x 8' 3" (2.51m x 3.74m)

**Shower Room**

6' 2" x 6' 11" (1.87m x 2.11m)

**Rear Garden / Low Maintenance / Gate to Front**

**Single Garage and Well Landscaped Front Garden**





Members of the Guild of Property Professionals



Members of the Guild of Property Professionals



## Ground Floor

Approx. 89.1 sq. metres (958.9 sq. feet)

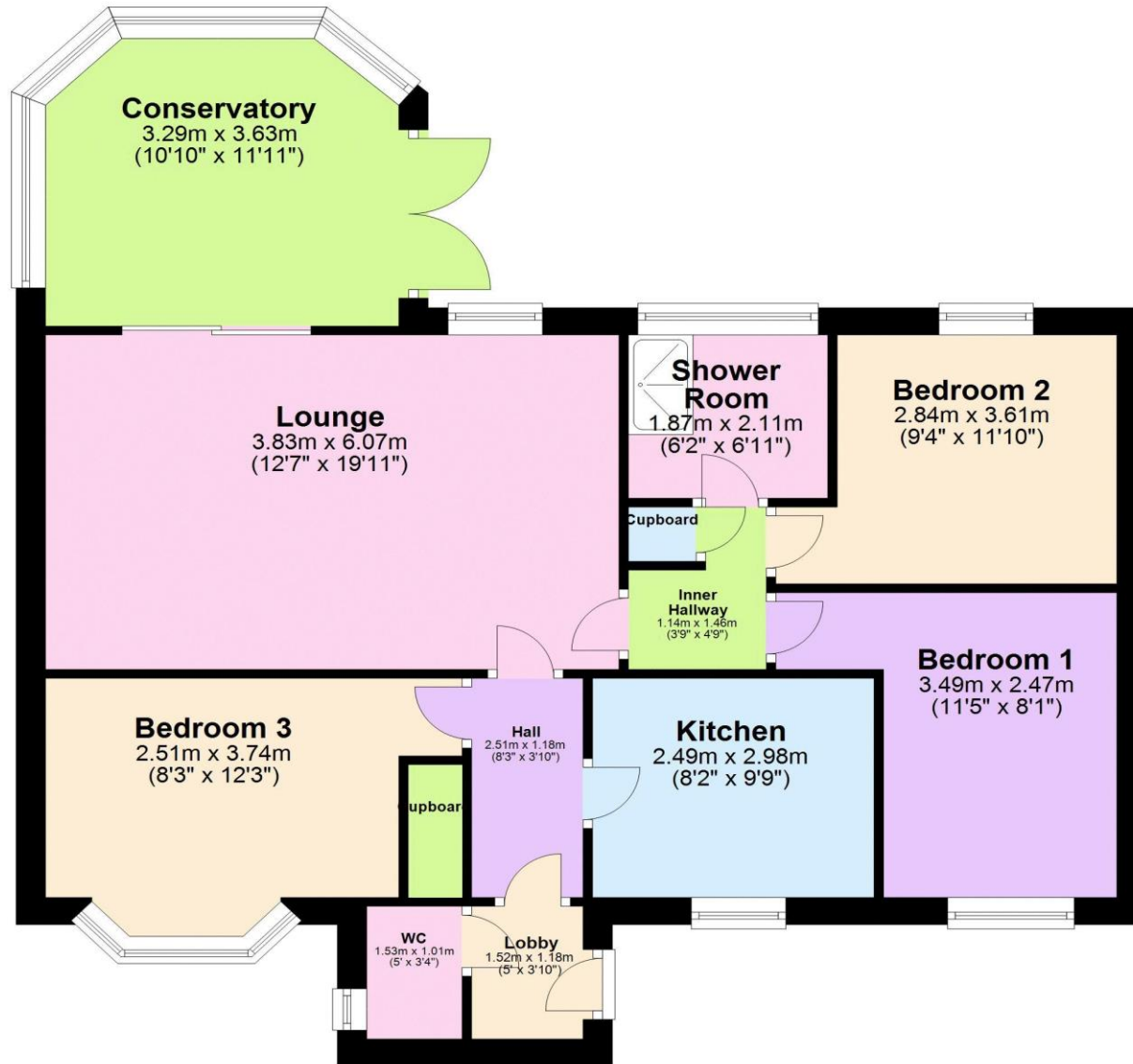

Members of the Guild of Property Professionals