

ESTAS



ESTATE AGENT
AWARDS 2021

BEST AGENCY
NETWORK

The Guild of Property
Professionals



Eastwood, Guide Price £110,000 - £115,000 2 Bed

Well appointed Sought After "Two Bed Ground Floor Apartment" in a much favoured Retirement Complex in Eastwood just a short walk from all local amenities Buses stop right outside to many destinations including Rayleigh, Southend Hospital, Southend Town, Etc. No Chain. Pets Permitted **EPC Rating: C**



ESSEX GUILD HOMES

WE VALUE PEOPLE, NOT JUST PROPERTY

Rayleigh Road, Essex, SS9 5PZ

Entrance Hall 9' 9" x 4' 9" (2.97m x 1.44m)

Lounge / Dining Area 17' nt 14' 2" x 12' 10" nt 8' 8" (5.18m x 3.91m)

Kitchen Area 9' 10" x 6' (2.99m x 1.83m)

Bedroom One 9' 7" x 13' (2.93m x 3.96m)

Bedroom Two 7' 1" x 9' 10" (2.16m x 2.99m)

Shower Room 5' 5" x 5' 2" (1.66m x 1.58m)

Energy Performance Rating: C

Council Tax Band: D

Inspected By: Thomas Devlin-James

Disclaimer: The measurements indicated are supplied for guidance only, potential buyers are advised to re-check the measurements before committing to any expense.





Members of the Guild of Property Professionals

Ground Floor

Approx. 51.8 sq. metres (557.2 sq. feet)

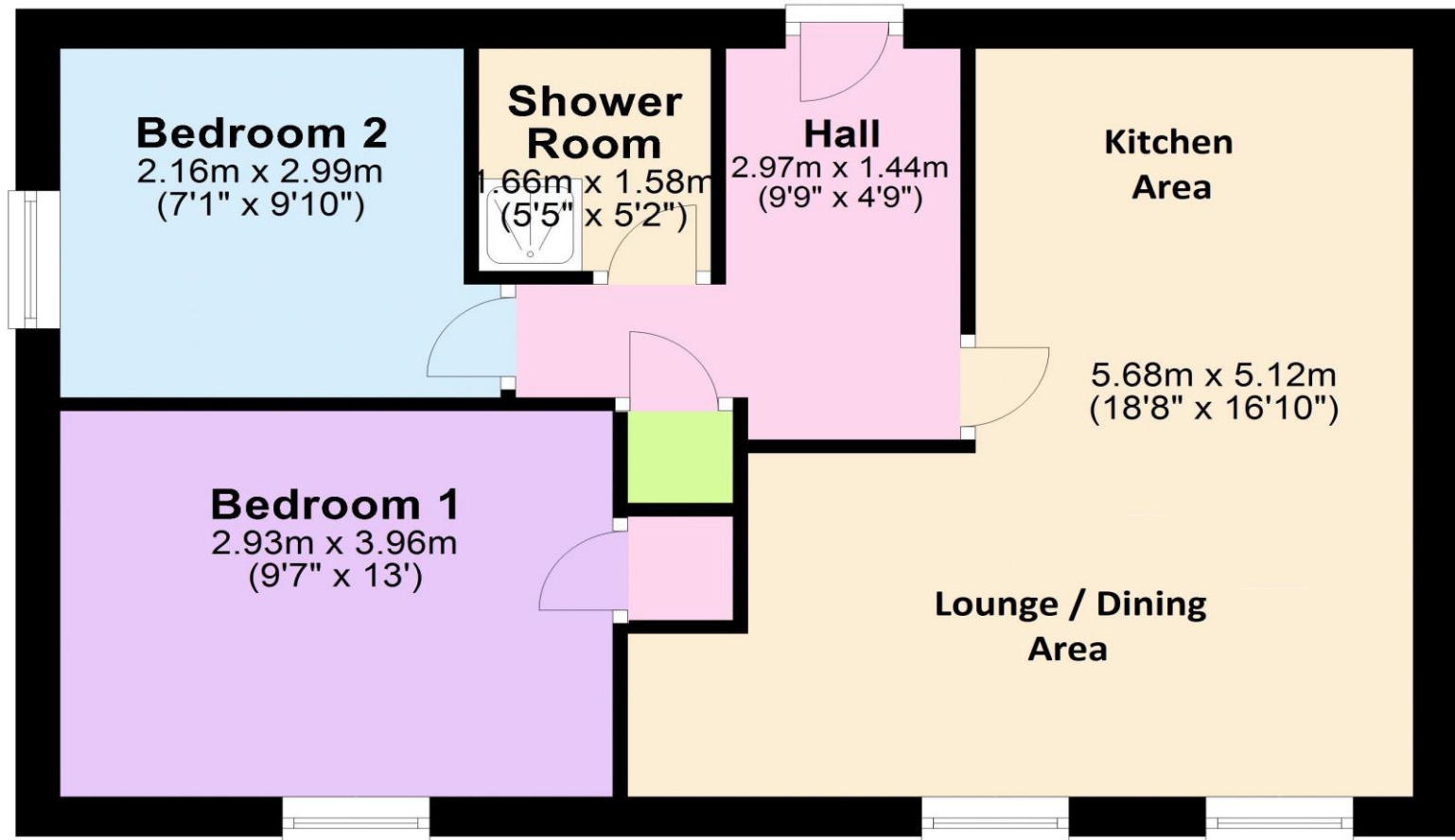

Total area: approx. 51.8 sq. metres (557.2 sq. feet)

Members of the Guild of Property Professionals